



TRACOE

Freevent XtraCare Mini

Effective humidification and filtration
for optimal pulmonary health

Atos
Breathing-Speaking-Living

Freevent XtraCare Mini is a heat and moisture exchanger (HME) with a highly effective electrostatic filter. It contains a hygroscopic foam core which captures heat and moisture as the patient exhales and then releases this heat and moisture during inhalation. Additionally, the filter provides protection against airborne particles, including viruses and bacteria, with a filtration efficiency of more than 98%.^{*1,2} It is intended for spontaneously breathing pediatric patients with a tracheostomy tube.

The negative impact of a tracheostomy on pulmonary health

A tracheostomy bypasses upper airway functions which negatively impacts humidification, filtration, and secretion management. The tracheostomy creates an open portal of entry for unconditioned air, viruses, bacteria and other fine airborne particles into the lower airways and may heighten infection risk.

Also, the use of a tracheostomy tube can irritate the mucosa of the trachea, further increasing infection risk. It has been found that children who require tracheostomy tubes are at increased risk for bacterial tracheopulmonary infections due to the bacterial colonization of the airway.^{3,4,5} Bacterial pneumonia is the most common reason for hospitalization in children with tracheostomies.³

An efficient HME with high filtering capability

Freevent Xtracare Mini combines an HME with a bi-directional filter. It helps protect children with tracheostomies by effectively humidifying and filtering the air they inhale. It is also designed to filter the exhaled air to protect those around them.

Freevent XtraCare Mini has a compact design, tailored for pediatric patients. The transparent connector facilitates monitoring of secretions and is compatible with tracheostomy tubes with an ISO 15mm connector. Freevent XtraCare Mini is for daily use up to 24 hours** and provides protection with a filtration efficiency of more than 98%.^{*1,2}



*** Please note: Since pathogens can enter and leave the human body in other ways (such as the mouth, nose, and eyes), Freevent XtraCare Mini can never guarantee complete protection.**

**** HMEs should be changed at least every 24 hours, or if they are soiled, dropped or clogged.**

Performance and Facts

| | |
|---------------------------------------|--------------------------------------|
| Moisture loss at VT = 250 ml | 13.5 mg/l |
| Bacterial filtration efficiency (BFE) | >99% ¹ (15 l/min) |
| Viral filtration efficiency (VFE) | >98% ² (15 l/min) |
| Dead space | 6.1 ml |
| Pressure drop 10 l/min | 45 Pa |
| Tidal volume range | 30-250 ml |
| Oxygen supply | Freevent O ₂ Adaptor Mini |
| Made in | Sweden |

Single patient use only, disposable. Individually packed products

If supplemental oxygen is needed

Freevent XtraCare Mini can be combined with Freevent O₂ Adaptor Mini to administer supplemental oxygen.

The Freevent O₂ Adaptor Mini:

- Connects to the HME with an audible click to confirm it's securely in place
- Connects to 3.2mm I.D. oxygen tubing
- Should be replaced at least every 24 hours, or when it becomes dirty, contaminated or shows any signs of damage
- Can be removed and used again within 24 hours for the same patient, if needed
- For single patient use only
- Products are individually packed

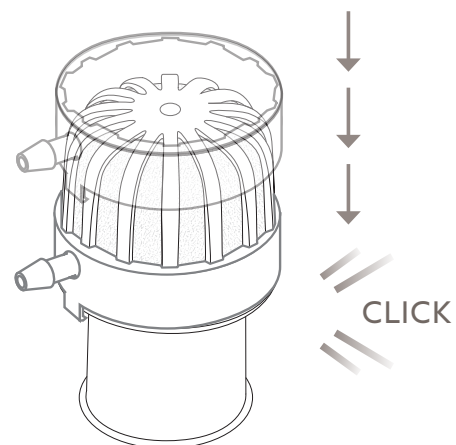







References:

1. Bacterial Filtration Efficiency (BFE) GLP Report, Nelson Laboratories, Salt Lake City, USA
2. Viral Filtration Efficiency (VFE) GLP Report, Nelson Laboratories, Salt Lake City, USA
3. Zhu H, Das P, Roberson DW, Jang J, Skinner ML, Paine M, Yuan J, Jay Berry J. Hospitalizations in children with preexisting tracheostomy: a national perspective. Laryngoscope. 2015 Feb;125(2):462-8
4. Gipsman A, Prero M, Toltzis P, Craven D. Tracheobronchitis in children with tracheostomy tubes: Overview of a challenging problem. Pediatr Pulmonol. 2022;57(4):814-821.
5. Woods CR. Tracheobronchitis associated with tracheostomy tubes and endotracheal intubation in children. 2022. UpToDate.com

Always read the Instructions for Use before starting to use any of the products.
For Instructions for Use, please visit: www.atosmedical.com/ifu

| Item | REF # | Product | Qty |
|---|-------|--------------------------------------|--------|
|  | 8004 | Freevent XtraCare Mini White | 30 pcs |
|  | 8007 | Freevent O ₂ Adaptor Mini | 10 pcs |

Contact your Tracoe Sales Specialist with any questions or reach out to us at info.us@atosmedical.com

-  1.800.217.0025
-  info.us@atosmedical.com
-  www.atosmedical.us

